

분류기

Shunt

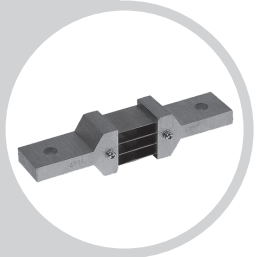
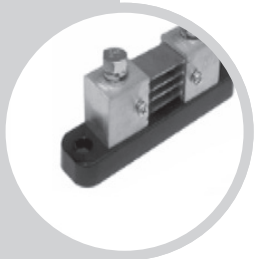

정격 및 외형도
Specifications & Dimension·····260

SHUNT [Voltage Drop 50mV]

WYSH-Series [10~5000A]

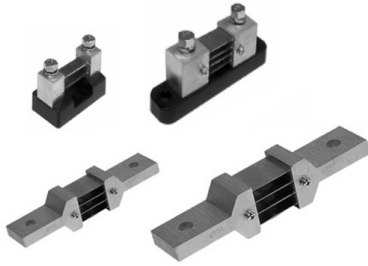

● Feature

- Accuracy class 1.0%
- 2' nd Drop Voltage : DC,50mV (standard)
- DC100mV Type 적용시 당사와 Dimension을 협의 하십시오.
- Class 0,2% ~ 0,5% (Option)

● Connection

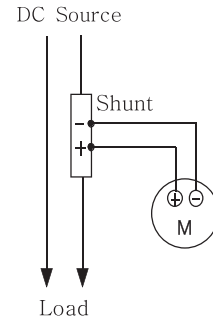

● Specification

	WYSH-10~75				WYSH-100~350			WYSH-400	WYSH-500	WYSH-600	WYSH-700	WYSH-750	WYSH-800	WYSH-1000	WYSH-1200	WYSH-1500	WYSH-2000	WYSH-2500	WYSH-3000	WYSH-4000	WYSH-5000	WYSH-6000
	10A	15A	20A	30A	100A	120A	150A	400A	500A	600A	700A	750A	800A	1000A	1200A	1500A	2000A	2500A	3000A	4000A	5000A	6000A
Drop Voltage	50mV							50mV														
Accuracy	1,0%							1,0%														
Isolation Resistance	10M Ω							None														
Dielectric Strength	2000V/1min							None														

※ Drop Voltage : 60mV / 100mV 별도 주문요망. (Size 변경 될 수 있으므로 협의 후 진행바랍니다.)

● Model : SH-10~75

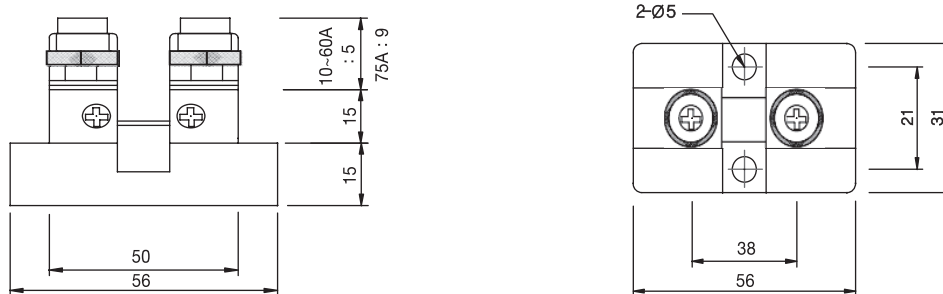

● Model : SH-100~350

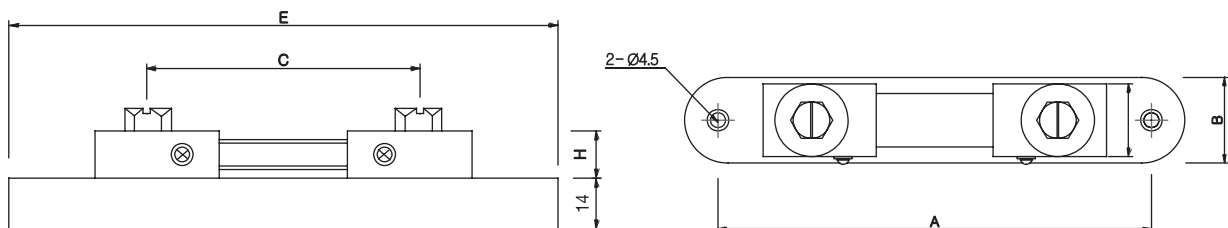

치수공차 : $\pm 0.5\text{mm}$

CURRENT	A	B	C	E	H
100A	108	26	69	129	12,5
150A	108	26	69	129	13
200A	108	26	69	129	15
300A	108	26	69	129	15
350A	108	26	55	129	16,5

SHUNT [Voltage Drop 50mV]

WYSH-Series [10~5000A]

● Model : SH-400~750

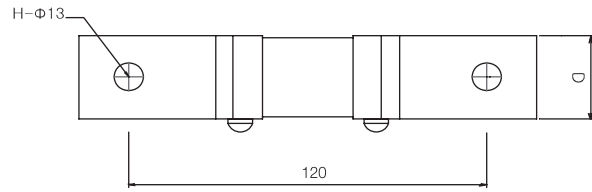
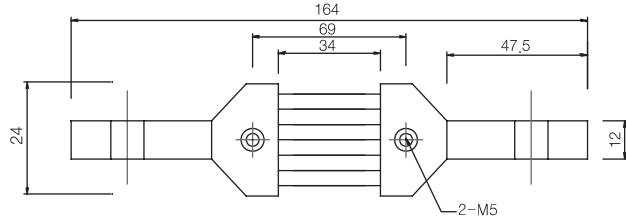

TYPE	SH-400	SH-500	SH-600	SH-700	SH-750
	400A	500A	600A	700A	750A
D	40	40	45	45	45
H	2	2	2	2	2

● Model : SH-800~1200

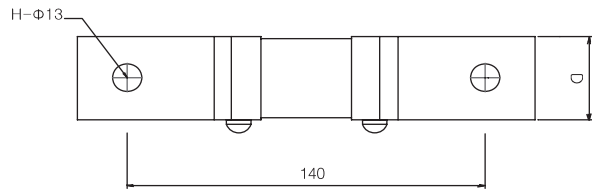
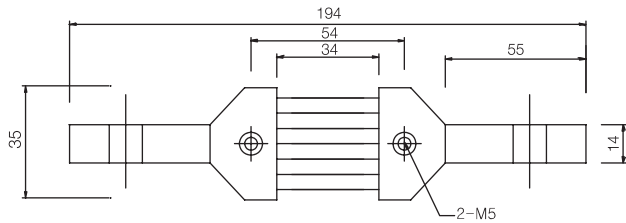

TYPE	SH-800	SH-1000	SH-1200
	800A	1000A	1200A
D	50	60	60
H	2	2	2

● Model : SH-1500~2000

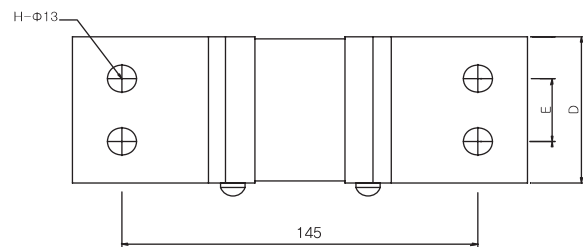
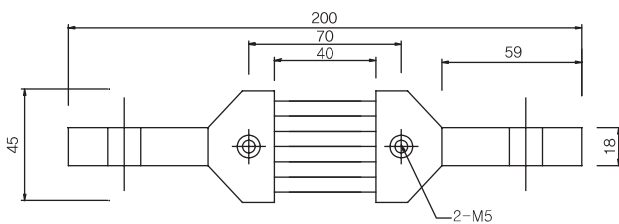

TYPE	SH-1500	SH-2000
	1500A	2000A
D	75	85
E	20	20
H	4	4

H
V
/
C
T
고압분류기

H
V
/
V
T
·
M
O
F
고압변류기

L
V
/
C
T
저압분류기

L
V
/
V
T
저압변류기

R
E
L
A
Y
보통계전기

E
L
D
누전분류기

G
F
R
지락계전기

Z
G
T
영상변류기

M
E
T
E
R
지식전계기

S
P
D
서지보호기

S
H
U
N
T
분류기

SHUNT [Voltage Drop 50mV]

WYSH-Series [10~5000A]

● Model : SH-2500~3000

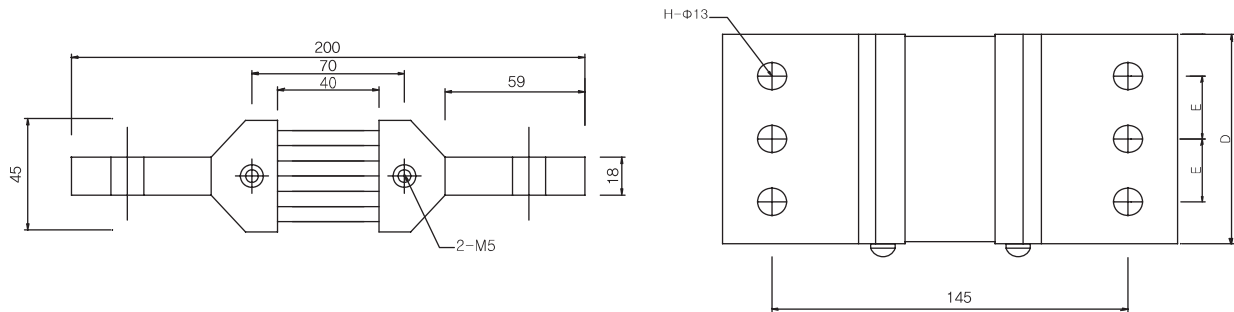

TYPE	SH-2500	SH-3000
	2500A	3000A
D	107	107
E	30	30
H	6	6

● Model : SH-4000~6000

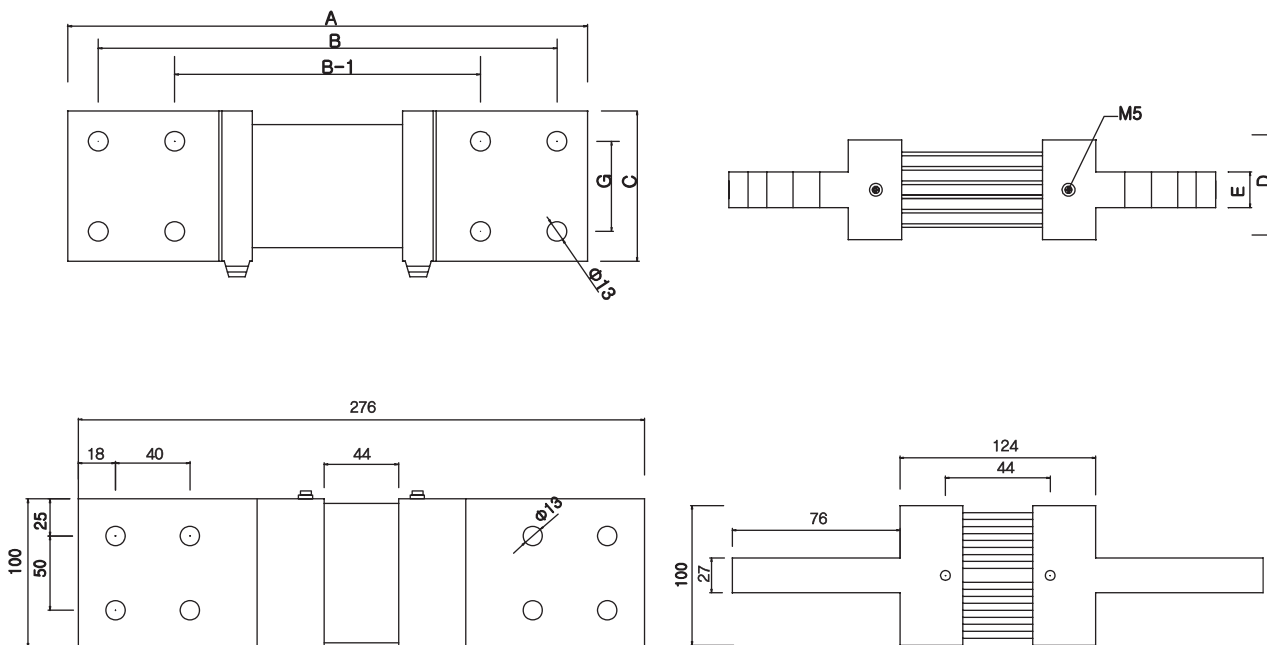

CURRENT	A	B	B-1	C	D	E	G
4000A	276	240	160	100	100	27	50
5000A	276	240	160	100	100	27	50
6000A	276	240	160	100	100	27	50